



# FLUSHING RING

The flushing flange or ring is used for flushing solution combined with diaphragm seal. This type of flushing flange or ring is clamped between process nozzle and diaphragm seal. The reducer flange is used to mount a larger diaphragm seal to a smaller process connection.



### Application:

The flushing ring is designed to be sandwiched between the process flange & the diaphragm seal. material collected in front of diaphragm can be flushed out through the flushing ports.

Material: ASTM 304/304LSS, ASTM 316/316LSS, HASTELLOY, MONEL, NCONEL, TANTALUM, PTFE, Other materials on request.

Size: 1/4" To 5" as per the ANSI B16.5

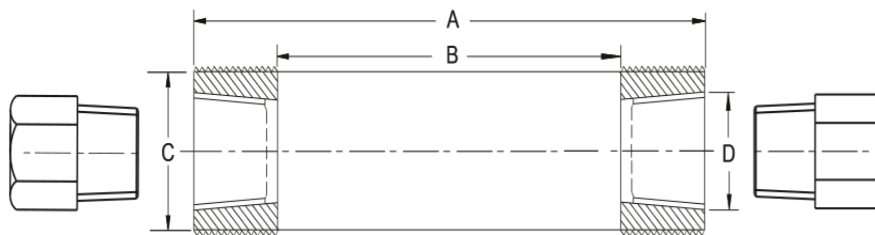

For flange type diaphragm seals

FLANGE SIZE	CLASS	A	B	C	D
1/2"	150 # to 600 #	35	12	30	1/4"NPT OR 1/2"NPT (F)
3/4"	150 # to 600 #	43	20	30	
1"	150 # to 600 #	51	25	30	
1 1/2"	150 # to 600 #	73	43	30	
2"	150 # to 600 #	92	62	30	
3"	150 # to 600 #	127	92	30	
4"	150 # to 600 #	157	92	30	
5"	150 # to 600 #	185.5	126	30	